

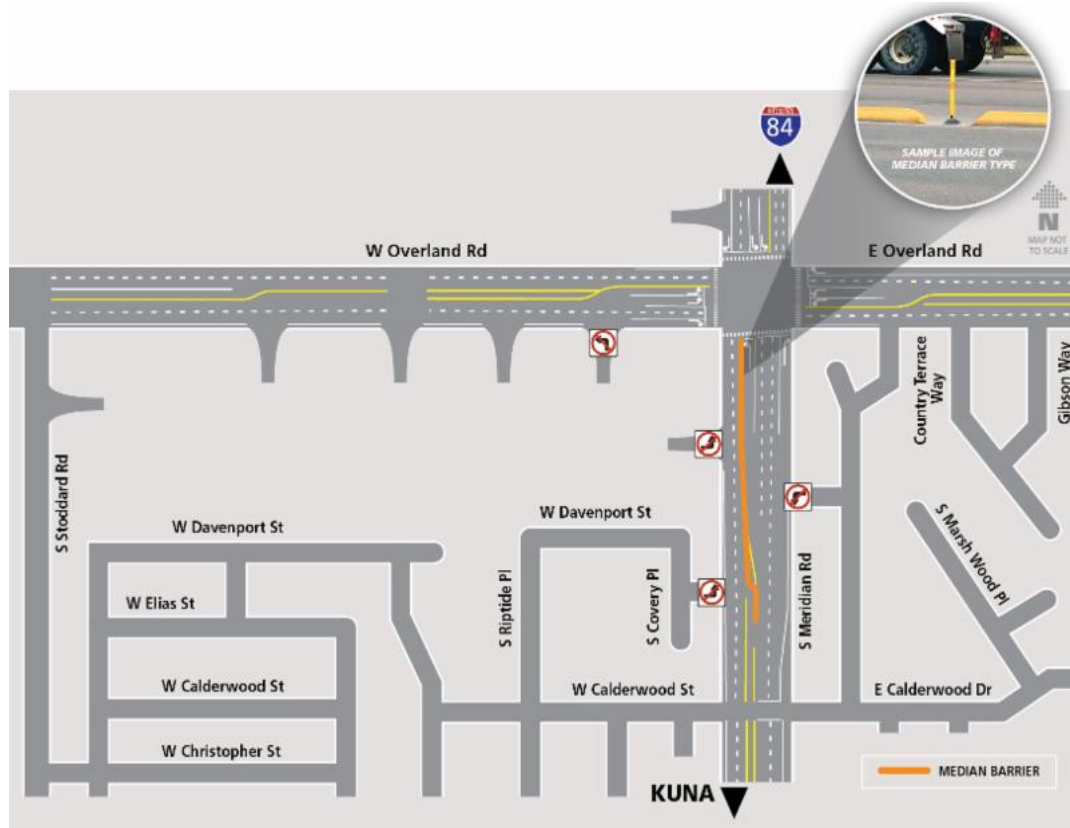

## Traffic pattern changes tomorrow morning at Meridian and Overland Roads

Tonight you can expect:

- The intersection of Meridian and Overland Roads will be re-striped and the signal will be adjusted to improve traffic flow. Please watch for signage and new lane markings.
- The median barrier will be added to Meridian Road between Calderwood and Overland roads.
- Crews will finish paving approaches (driveways) between Overland Road and Kuna.



Once the intersection work is complete, all lanes will remain open and the project is finished. However, motorists can anticipate intermittent shoulder closures through next week while the contractor does final cleanup activities.

FOR CONSTRUCTION UPDATES:

TEXT SH69 to 22828 | [itdprojects.org/projects/SH69](http://itdprojects.org/projects/SH69) | [Jennifer.gonzalez@itd.idaho.gov](mailto:Jennifer.gonzalez@itd.idaho.gov) | (208) 334-8938

